

DEHNguard YPV SCI ... (FM)

- DE Einbauanleitung
- GB Installation instructions
- IT Istruzioni di montaggio
- FR Instructions de montage
- NL Montagehandleiding
- ES Instrucciones de montaje
- PT Instruções de montagem
- DK Monteringsvejledning
- SE Monteringsanvisning
- FI Asennusohje
- GR Οδηγίες συναρμολόγησης
- PL Instrukcja montażu
- CZ Návod k montáži
- TR Montaj kılavuzu
- RU Инструкция по монтажу
- CN 安装说明
- HU Szerelési útmutató
- JP 設置説明書

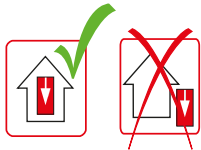

2 EN 50539-11...

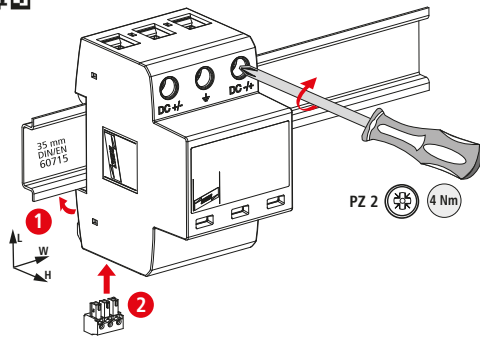

	DG YPV SCI 600 (FM)	DG YPV SCI 1000 (FM)
U <sub>CPV</sub>	≤ 600 V DC	≤ 1000 V DC
I <sub>total</sub>	40 kA (8/20)	40 kA (8/20)
I <sub>max</sub>	25 kA (8/20)	25 kA (8/20)
I <sub>scpv</sub>	1 kA	1 kA
I <sub>PE, AC</sub>	≤ 500 μA	≤ 500 μA
I <sub>PE, DC</sub>	≤ 25 μA	≤ 25 μA
θ°	-40°C ... +80°C	-40°C ... +80°C
φ	5% ... 95%	5% ... 95%
IP 1)	20	20
failure behavior	open circuit	open circuit
Ausfallverhalten	Abtrennung	Abtrennung
L x W x H	90 mm x 54 mm x 72 mm	

	min. □ DC+ / -, DC- / +, ↓	max. □ DC+ / -, DC- / +, ↓
	1.5 mm <sup>2</sup>	35 mm <sup>2</sup>

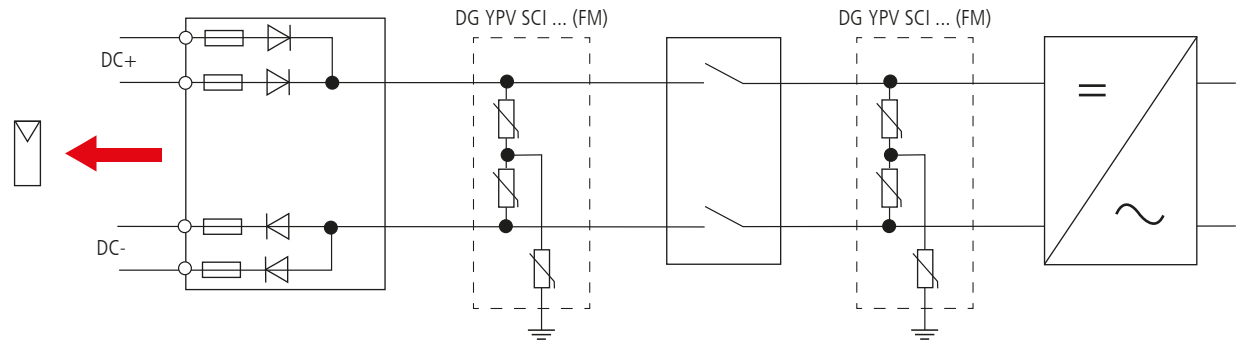

DG YPV SCI 600 (FM)

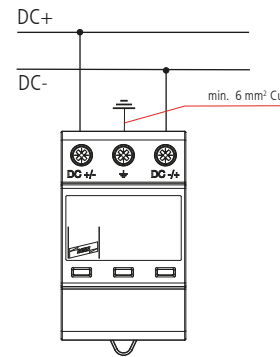

DG YPV SCI 1000 (FM)

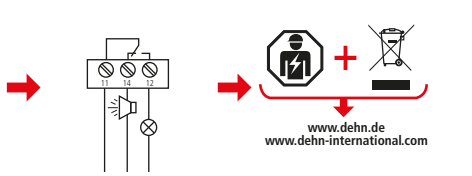
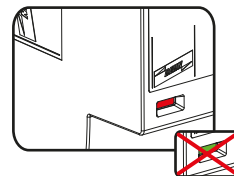
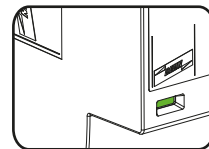
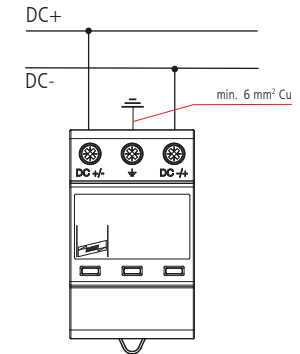

www.dehn.de  
www.dehn-international.com

DEHNguard YPV SCI ... FM	
DG YPV SCI 600 FM DG YPV SCI 1000 FM	
U <sub>N</sub> / I <sub>N</sub>	AC: 250 V / 0.5 A
	DC: 250 V / 0.1 A 125 V / 0.2 A 75 V / 0.5 A
max. 1.5 mm <sup>2</sup>	

